

General Electric Company

Schenectady, N.Y.

March, 1920

*Bulletin No. 5456I

PARTS OF AIR BRAKE EQUIPMENT STRAIGHT AIR BRAKE CYLINDERS

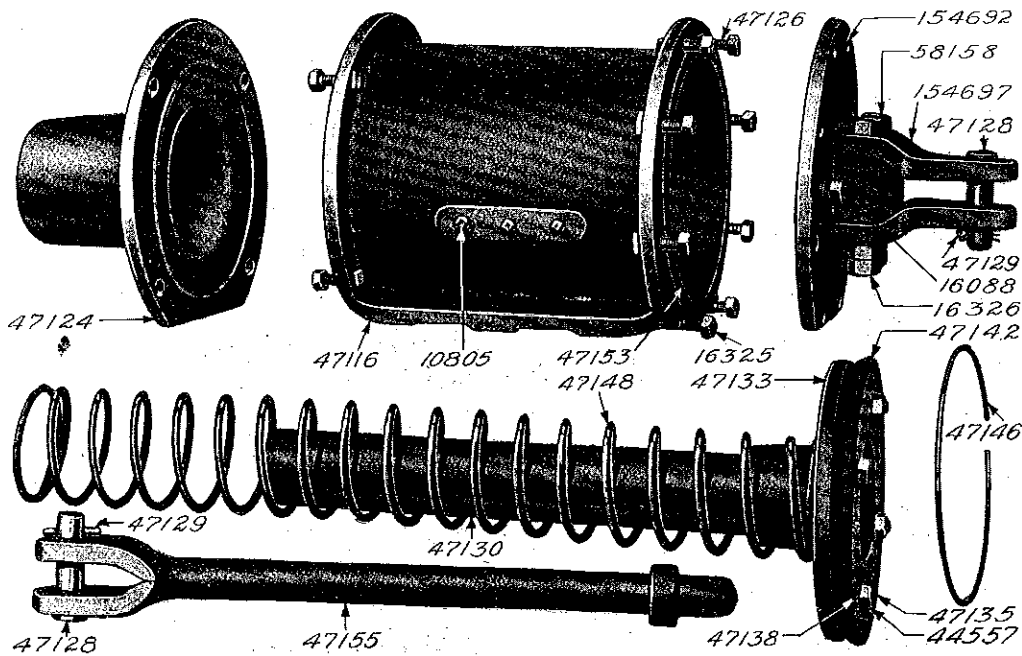

Cat. No.	Description
47349	6 in. straight air brake cylinder, includes push rod.....
38560	8 in. straight air brake cylinder, includes push rod.....
38561	10 in. straight air brake cylinder, includes push rod.....
38562	12 in. straight air brake cylinder, includes push rod.....
38563	14 in. straight air brake cylinder, includes push rod.....
136160	16 in. straight air brake cylinder, includes push rod.....

NOTE.—The accompanying illustration of the 10 in. straight air brake cylinder is representative of the 6 in., 8 in., 12 in., 14 in. and 16 in. cylinders. Where differences occur they are due mainly to size.

Following are the parts:

47114	CYLINDER BODY (6 in. by 12 in.).....
47115	Cylinder body (8 in. by 12 in.).....

NOTE.—Data subject to change without notice.

*Supersedes in part Bulletin No. 4589,
Second Edition.

54561-2 Parts of Air Brake Equipment

Cat. No.	Description
47116	Cylinder body (10 in. by 12 in.)
47117	Cylinder body (12 in. by 12 in.)
154686	Cylinder body (14 in. by 12 in.)
154687	Cylinder body (16 in. by 12 in.)
10805	Pipe plug for cylinder body ($\frac{1}{4}$ in. pipe)
47118	Pressure head, complete, with brackets, for 6 in. cylinder
47119	Pressure head, complete, with brackets, for 8 in. cylinder
47120	Pressure head, complete, with brackets, for 10 in. cylinder
47121	Pressure head, complete, with brackets, for 12 in. cylinder
154688	Pressure head, complete, with brackets, for 14 in. cylinder
154689	Pressure head, complete, with brackets, for 16 in. cylinder
154690	Pressure head, only, for 6 in. cylinder
154691	Pressure head, only, for 8 in. cylinder
154692	Pressure head, only, for 10 in. cylinder
154693	Pressure head, only, for 12 in. cylinder
154694	Pressure head, only, for 14 in. cylinder
154695	Pressure head, only, for 16 in. cylinder
16088	Pipe plug for pressure head, for 6 in., 8 in., 10 in., 12 in. and 14 in. cylinders ($\frac{3}{4}$ in. pipe)
16089	Pipe plug for pressure head, for 16 in. cylinder ($\frac{1}{2}$ in. pipe)
47128	Hinge pin for pressure head, for 6 in., 8 in., 10 in., and 12 in. cylinders ($1\frac{3}{8}$ in. by $3\frac{1}{2}$ in. fill. h.)
154696	Hinge pin for pressure head, for 14 in. and 16 in. cylinders ($1\frac{7}{8}$ in. by $3\frac{1}{2}$ in. fill. h.)
147129	Spring cotter for Nos. 47128, 154696 ($\frac{3}{8}$ in. by $2\frac{1}{4}$ in.)
154697	Bracket for pressure head, for 6 in., 8 in., 12 in. and 14 in. cylinders
54698	Bracket for pressure head, for 16 in. cylinder
58158	Bolt fastening Nos. 154697, 154698 in position ($\frac{3}{4}$ in.-10, $5\frac{1}{4}$ in. hex. h.)
16326	Nut for No. 58158 ($\frac{3}{4}$ in.-10, $\frac{3}{4}$ in. hex. rough, st'd)
47122	Non-pressure head for 6 in. cylinder
47123	Non-pressure head for 8 in. cylinder
47124	Non-pressure head for 10 in. cylinder
47125	Non-pressure head for 12 in. cylinder
154699	Non-pressure head for 14 in. cylinder
154700	Non-pressure head for 16 in. cylinder
47126	Bolt fastening pressure and non-pressure heads to cylinder body for the 6 in., 8 in. and 10 in. cylinders and non-pressure head to cylinder body for the 12 in. cylinder ($\frac{1}{2}$ in.-13, 2 in. tee h.)
47127	Bolt fastening pressure head to cylinder body for the 12 in. cylinder and pressure and non-pressure heads to cylinder body for the 14 in. cylinder ($\frac{5}{8}$ in.-11, $2\frac{1}{2}$ in. tee h.)
154701	Bolt fastening pressure and non-pressure heads to cylinder body for the 16 in. cylinder ($\frac{5}{8}$ in.-11, $2\frac{1}{4}$ in. tee h.)
16325	Nut for No. 47126 ($\frac{1}{2}$ in.-13, $\frac{1}{2}$ in. hex. rough, st'd)
16074	Nut for Nos. 47127, 154701 ($\frac{5}{8}$ in.-11, $\frac{5}{8}$ in. hex. rough, st'd)
47131	Piston, complete, with piston rod, studs and nuts, for 6 in. cylinder
47132	Piston, complete, with piston rod, studs and nuts, for 8 in. cylinder
47133	Piston, complete, with piston rod, studs and nuts, for 10 in. cylinder
47134	Piston, complete, with piston rod, studs and nuts, for 12 in. cylinder
154702	Piston, complete, with piston rod, studs and nuts, for 14 in. cylinder
154703	Piston, complete, with piston rod, studs and nuts, for 16 in. cylinder
47130	Piston rod for Nos. 47131, 47132, 47133, 47134, 154703
154705	Piston rod for No. 154702
154706	Stud for No. 47131 ($\frac{1}{2}$ in.-13, $1\frac{3}{4}$ in. sp'l)
47135	Stud for Nos. 47132, 47133 ($\frac{1}{2}$ in.-13, 2 in. sp'l)
154707	Stud for Nos. 47134, 154702 ($\frac{1}{2}$ in.-13, $2\frac{3}{8}$ in. sp'l)
154708	Stud for No. 154703 ($\frac{1}{2}$ in.-13, $2\frac{3}{8}$ in. sp'l)
44557	Nut for studs ($\frac{1}{2}$ in.-13, $\frac{7}{8}$ in. across flats, $\frac{3}{8}$ in. thick, hex. cham. one side)
47136	Piston follower for 6 in. cylinder
47137	Piston follower for 8 in. cylinder
47138	Piston follower for 10 in. cylinder

Cat. No.	Description
47139	Piston follower for 12 in. cylinder.....
154709	Piston follower for 14 in. cylinder.....
154710	Piston follower for 16 in. cylinder.....
47140	Leather packing for 6 in. cylinder.....
47141	Leather packing for 8 in. cylinder.....
47142	Leather packing for 10 in. cylinder.....
47143	Leather packing for 12 in. cylinder.....
154711	Leather packing for 14 in. cylinder.....

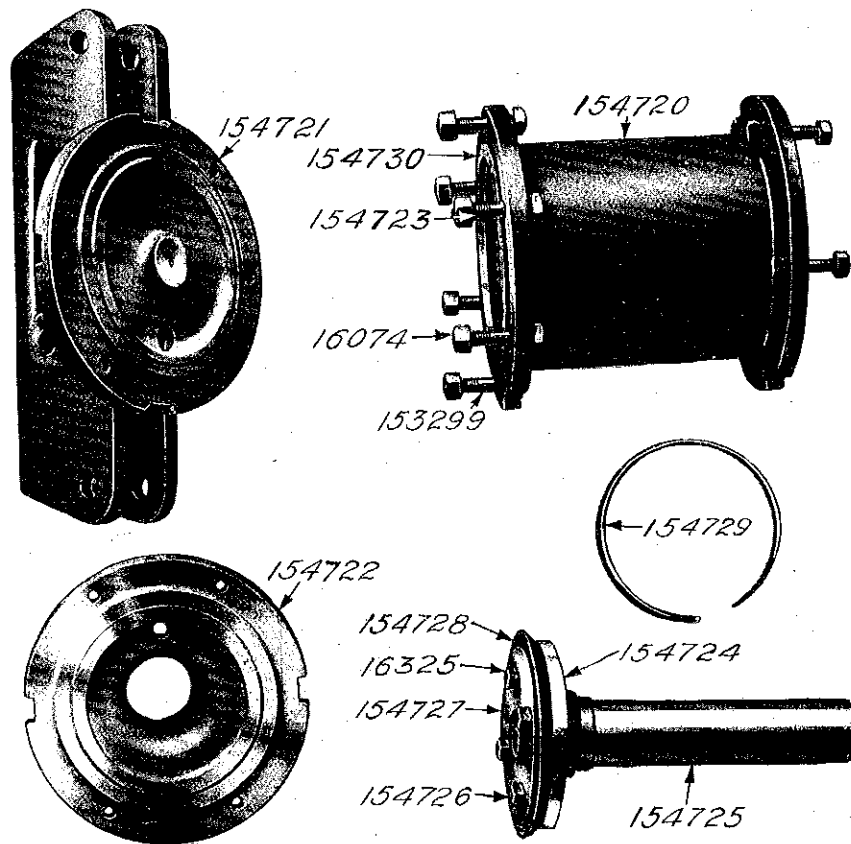

Cat. No. 120465

154712	Leather packing for 16 in. cylinder.....
47144	Expander for 6 in. cylinder.....
47145	Expander for 8 in. cylinder.....
47146	Expander for 10 in. cylinder.....
47147	Expander for 12 in. cylinder.....
154713	Expander for 14 in. cylinder.....
154714	Expander for 16 in. cylinder.....
47148	Release spring for 6 in., 8 in., 10 in. and 12 in. cylinders.....
154715	Release spring for 14 in. and 16 in. cylinders.....
47151	Rubber gasket for 6 in. cylinder.....
47152	Rubber gasket for 8 in. cylinder.....

GENERAL ELECTRIC COMPANY

54561-4 Parts of Air Brake Equipment

Cat. No.	Description
47153	Rubber gasket for 10 in. cylinder.....
47154	Rubber gasket for 12 in. cylinder.....
154716	Rubber gasket for 14 in. cylinder.....
154717	Rubber gasket for 16 in. cylinder.....
47155	Push rod for 6 in., 8 in., 10 in. and 12 in. cylinders.....
154718	Push rod for 14 in. cylinder.....
154719	Push rod for 16 in. cylinder.....
47128	Hinge pin for No. 47155 ($1\frac{3}{8}$ in. by $3\frac{1}{2}$ in. fill. h.).....
154696	Hinge pin for Nos. 154718, 154719 ($1\frac{3}{8}$ in. by $3\frac{1}{2}$ in. fill. h.).....
47129	Spring cotter for Nos. 47128, 154696 ($\frac{3}{8}$ in. by $2\frac{1}{4}$ in.).....

COMBINED HAND AND AIR BRAKE CYLINDER

120465	8 in. by 10 in. combined hand and air brake cylinder, does not include push rod..... <i>Following are the parts:</i>
154720	CYLINDER BODY.....
154721	Base for cylinder body.....
154722	Cylinder head.....
154723	Short bolt fastening cylinder body to base ($\frac{5}{8}$ in.-11, $2\frac{1}{2}$ in. sq. h.).....
153299	Long bolt fastening cylinder body to base ($\frac{5}{8}$ in.-11, 3 in. sq. h.).....
16074	Nut for Nos. 154723, 153299 ($\frac{5}{8}$ in.-11, $\frac{5}{8}$ in. rough, st'd).....
154724	Piston, complete, with piston rod, studs and nuts.....
154725	Piston rod.....
154726	Stud for piston ($\frac{1}{2}$ in.-13, $1\frac{3}{4}$ in. sp'l).....
16325	Nut for stud ($\frac{1}{2}$ in.-13, $\frac{1}{2}$ in. hex. rough, st'd).....
154727	Piston follower.....
154728	Leather packing.....
154729	Expander.....
154730	Rubber gasket for cylinder body, base and head ($7\frac{3}{16}$ in. by $9\frac{1}{8}$ in. by $\frac{1}{16}$ in. thick).....

GENERAL ELECTRIC COMPANY

SCHENECTADY, N. Y., U. S. A.

Sales Offices in all Principal Cities